

Seat Track

Removal

1. Remove the front safety belt buckle. For additional information, refer to [Front Safety Belt Buckle \(76.73.30\)](#) (Section 501-20)
2. Remove the front seat cushion side trim.
 - Remove the 2 Torx screws.
 - Release from the 4 clips.

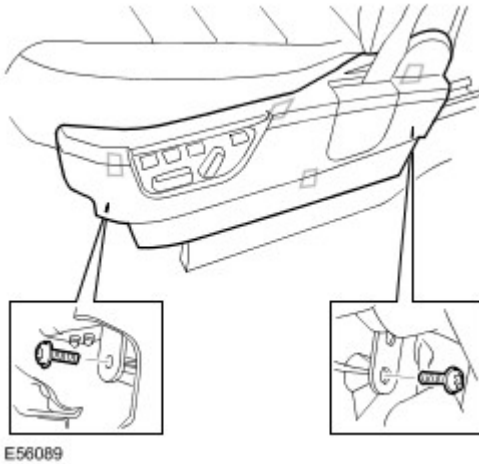

3. Remove the front seat base trim.
 - Remove the screw.
 - Release the 2 clips.

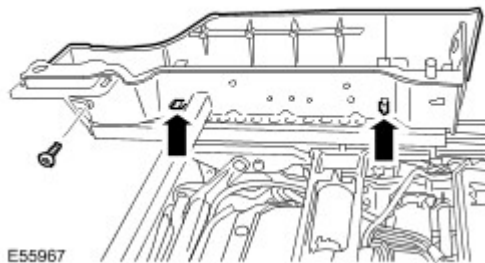

4. Remove the front seat base.
 - Remove the 6 nuts.

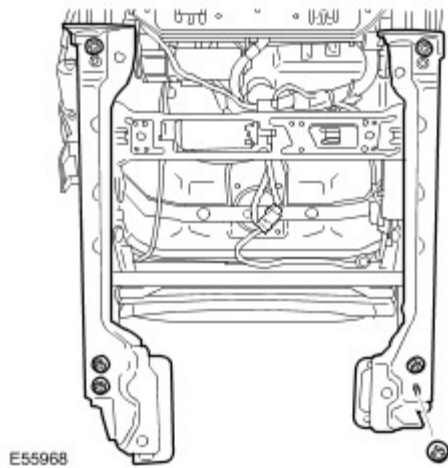

5. Remove the front seat cushion assembly.
- ▶ Release and disconnect the 2 electrical connectors.
 - ▶ Remove the 4 Torx bolts.

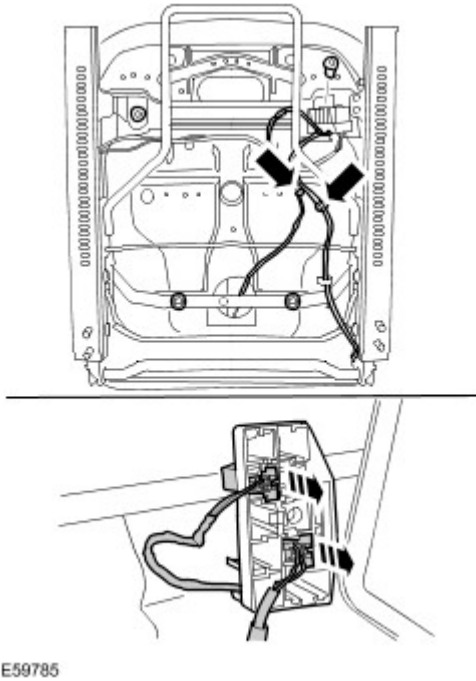

6. Remove the seat track assembly.
- ▶ Remove the 4 Torx bolts.

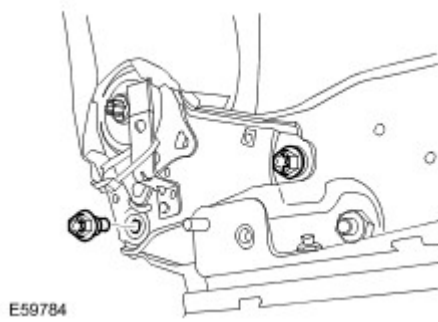

Installation

- 1 . Install the seat track assembly.
 - ▶ Tighten the Torx bolts to 25 Nm (18 lb.ft).
- 2 . Install the front seat cushion assembly.
 - ▶ Tighten the Torx bolts to 25 Nm (18 lb.ft).
 - ▶ Connect and secure the electrical connectors.
- 3 . Install the front seat base.
 - ▶ Tighten the nuts to 25 Nm (18 lb.ft).
- 4 . Install the front seat base trim.
 - ▶ Secure in the clips.
 - ▶ Tighten the screw.
- 5 . Install the front seat cushion side trim.
 - ▶ Secure in the clips.
 - ▶ Tighten the screws.
- 6 . Install the front safety belt buckle. For additional information, refer to [Front Safety Belt Buckle \(76.73.30\)](#) (Section 501-20)